

# Truss+ 2010

## Modify Truss System Grid

Chapter Two

# Modify Truss System Grid

- Select a truss system grid.
- Choose *Modify Truss System Grid* directly from “Truss+” menu.

The image shows a screenshot of the Revit software interface. The 'Truss+' menu is open, and the 'Modify Truss System Grid' option is highlighted with a red box. A red arrow points from this menu item to the '3D Truss System Grid: Configuration' dialog box. The dialog box displays a 3D model of a truss system and various configuration parameters.

**3D Truss System Grid: Configuration**

Type: Step Down - HE-HRJT-SB108-TCH1.5x3.5

Roof width: 631.874 | Truss thickness: 1.500 | Left roof line: 371.255

Pitch: 25.000 | Top chord depth: 3.500 | Right roof line: 1061.879

Overhang: 24.000 | Setback: 108.000 | Position of „L” return roof ridges:

Truss heel height: 4.000 | Truss spacing: 24.000 |  Form left ridge: 210.874

Second girder ply: 3 |  Form right ridge: 0.000

Update from roof

Jack configuration...  
 Jack trusses

Setback autoresearch left  
 Setback autoresearch right  
Actual setback: 108.000  
 Valley trusses will not be used  
Valley pitch: 25.000  
 Valley placement - Top down  
 Valley half spacing  
 Cut bottom chord of Valley  
Sheeting thickness: 0.000

OK Cancel

# Modify Truss System Grid

- To set corner and end rafters or jacks parameters, choose *Jack configuration*.

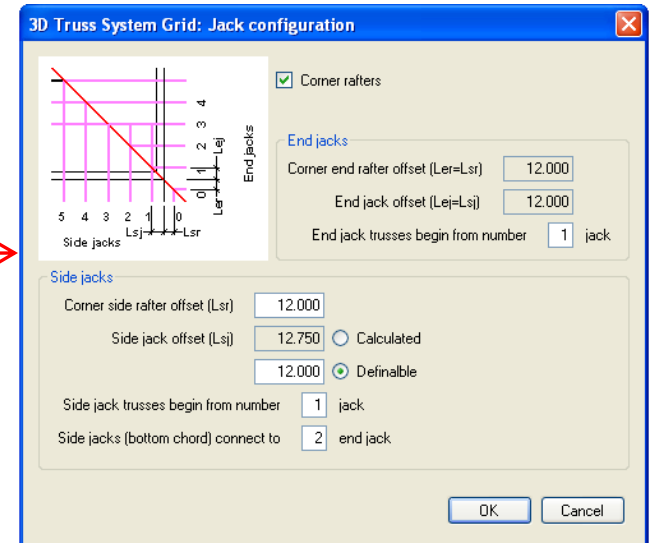
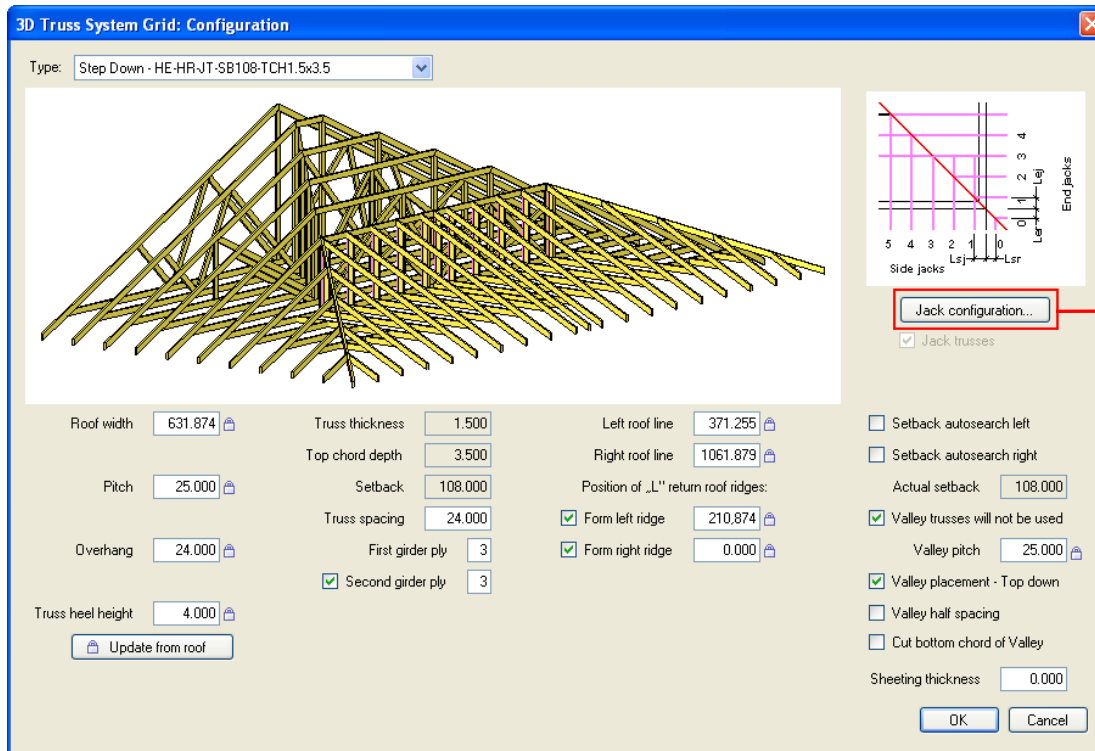

# Modify Truss System Grid

- $L_{sr}$  – a distance from the wall surface to the corner side rafter. Commonly  $L_{sr}=L_{er}$
- $L_{sj}$  – a distance from the wall surface to the side jack. This parameter can be calculated or user-defined. Commonly  $L_{sj}=L_{ej}$

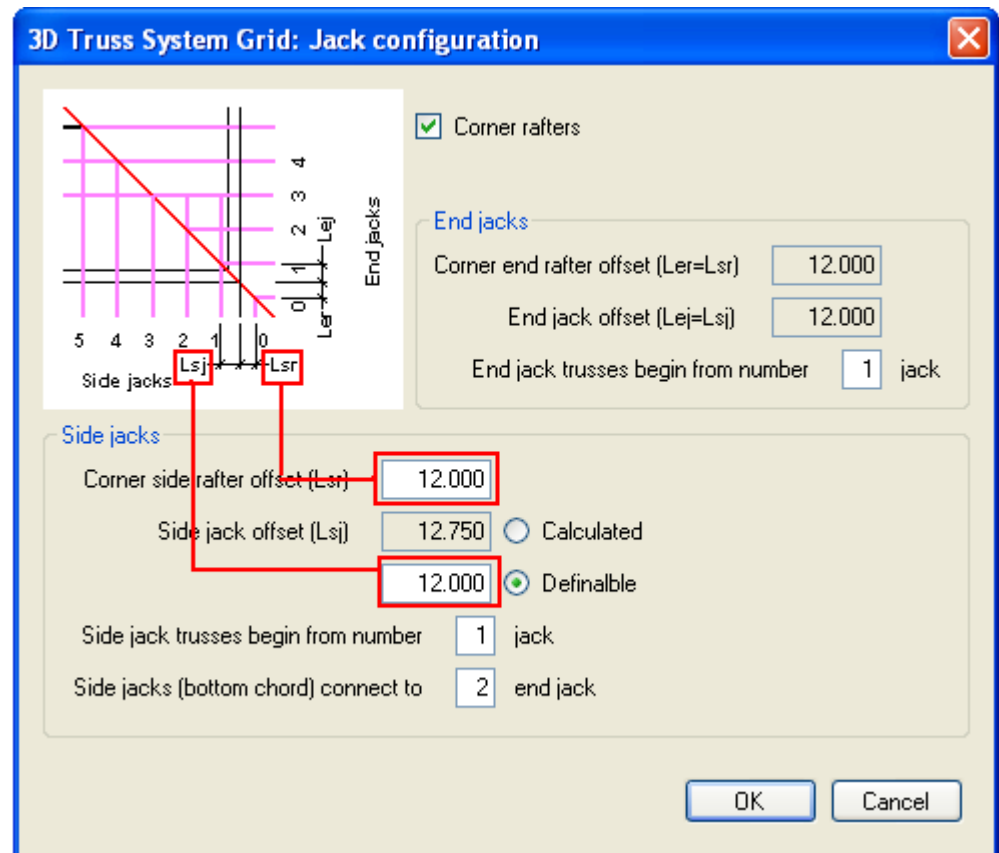

# Modify Truss System Grid

- *Corner rafters* – if this check box is ticked, corner rafters will be generated.
- *End jack trusses begin from number* – describes from which element are generated end jack trusses, instead of rafters.
- *Side jacks (bottom chord) connected to* – describes to which end jack are connected side jacks bottom chords.

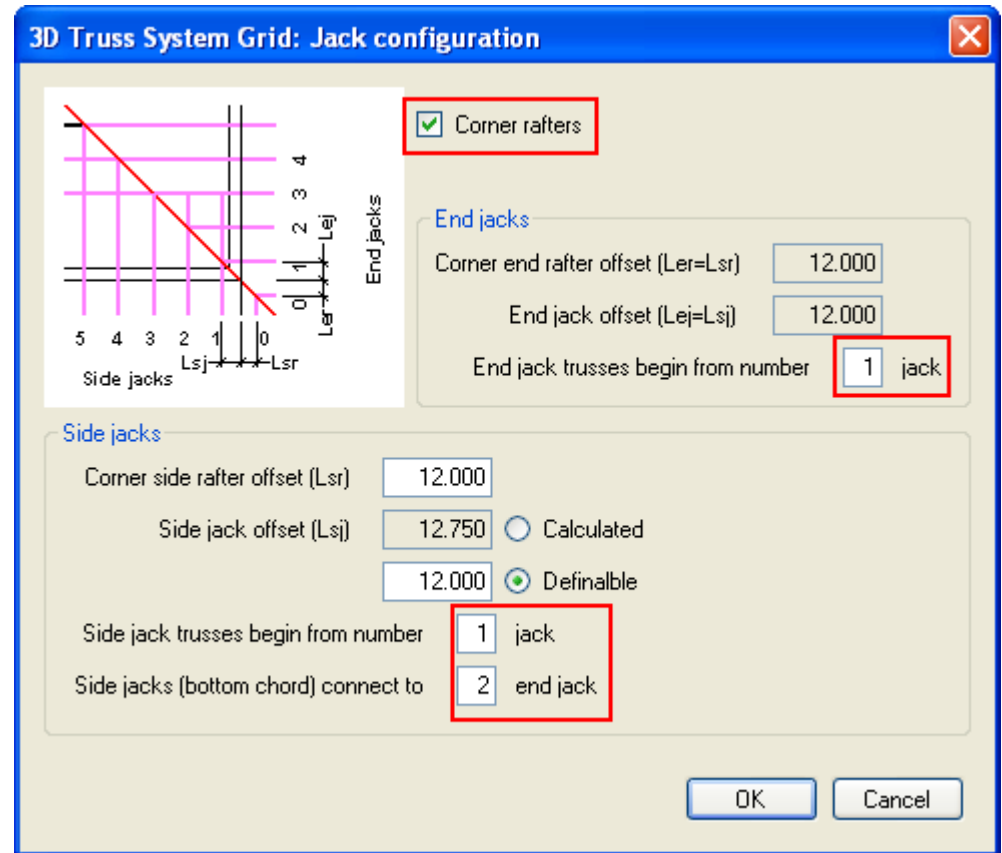

# Modify Truss System Grid

- If this  number is greater than this  than side jacks bottom chords will connect to the first end jack truss.

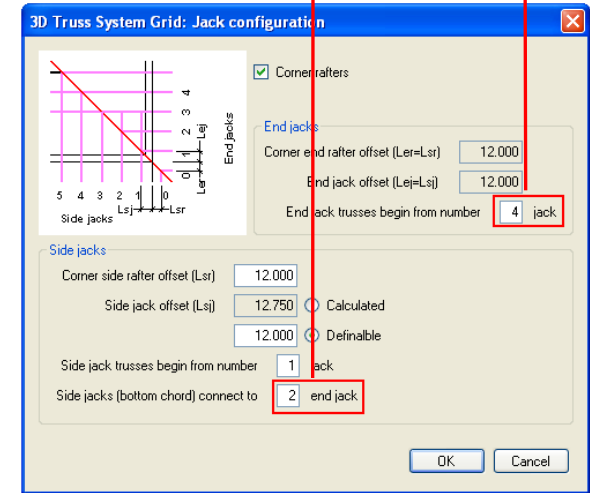

Side jacks (bottom chord) connect to  end jack

Side jacks (bottom chord) connect to  end jack

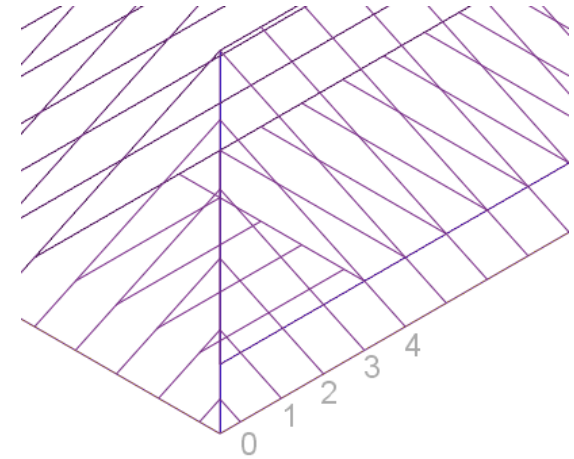
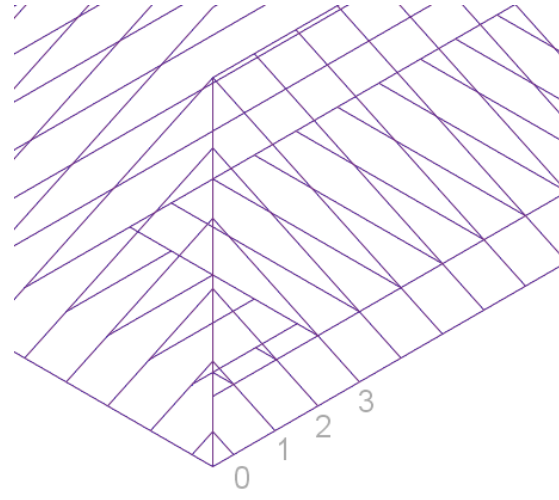
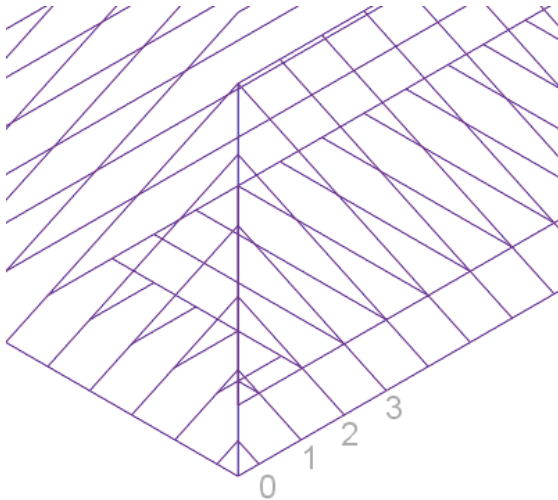

# Increase your productivity !



AGA CAD Ltd.  
Zalgirio 112A, LT-09300 Vilnius,  
Lithuania  
Tel. +370 5 2398111  
Fax +370 5 2398113  
Email [info@aga-cad.lt](mailto:info@aga-cad.lt)  
[info@tools4revit.com](mailto:info@tools4revit.com)  
[www.tools4revit.com](http://www.tools4revit.com)