



# Insert/Update Hip/Valley Rafter Rafter+FF

How to use Hip and Valley Rafter command step by step



# Before Proceeding

- Please read the topic *“How to frame correctly layers of the wood roof”* carefully.

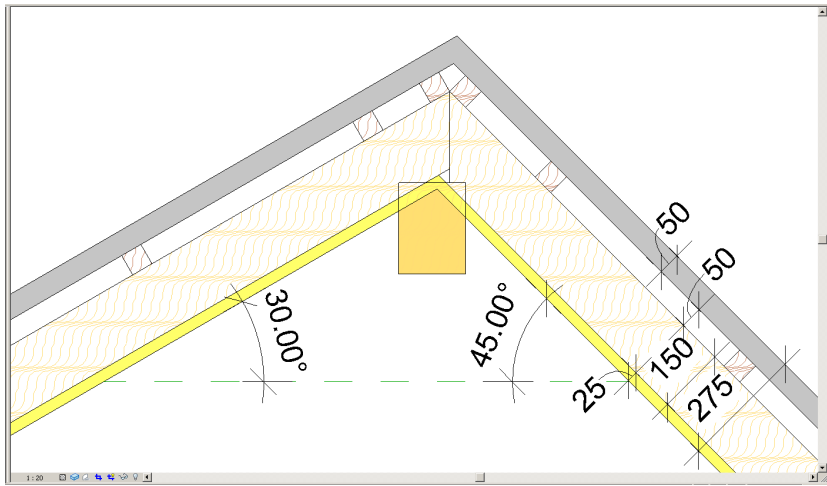

**Edit Assembly**

Family: Basic Roof  
Type: Wood Framing  
Total thickness: 275.0 (Default)

Function	Material	Thickness
1 Structure [1]	Roofing - Metal	50.0
2 Structure [1]	Wood - Stud La	50.0
3 Core Boundary	Layers Above W 0.0	
4 Structure [1]	Wood - Timber	150.0
5 Core Boundary	Layers Below W 0.0	
6 Structure [1]	Wood - Sheathi	25.0

Insert Delete

<< Preview OK

**Edit Assembly**

Family: Basic Roof  
Type: Wood Framing  
Total thickness: 175.0 (Default)

Function	Material	Thickness	Wraps	Variable
1 Core Boundary	Layers Above W 0.0			
2 Structure [1]	Wood - Timber	150.0		
3 Core Boundary	Layers Below W 0.0			
4 Structure [1]	Wood - Sheathi	25.0		

Insert Delete Up Down

<< Preview OK Cancel Help

# Create New Hip/Valley Rafter

- Select two rafter systems in adjacent slopes.
- Select the function *Insert/Update hip/valley rafter* from the menu.

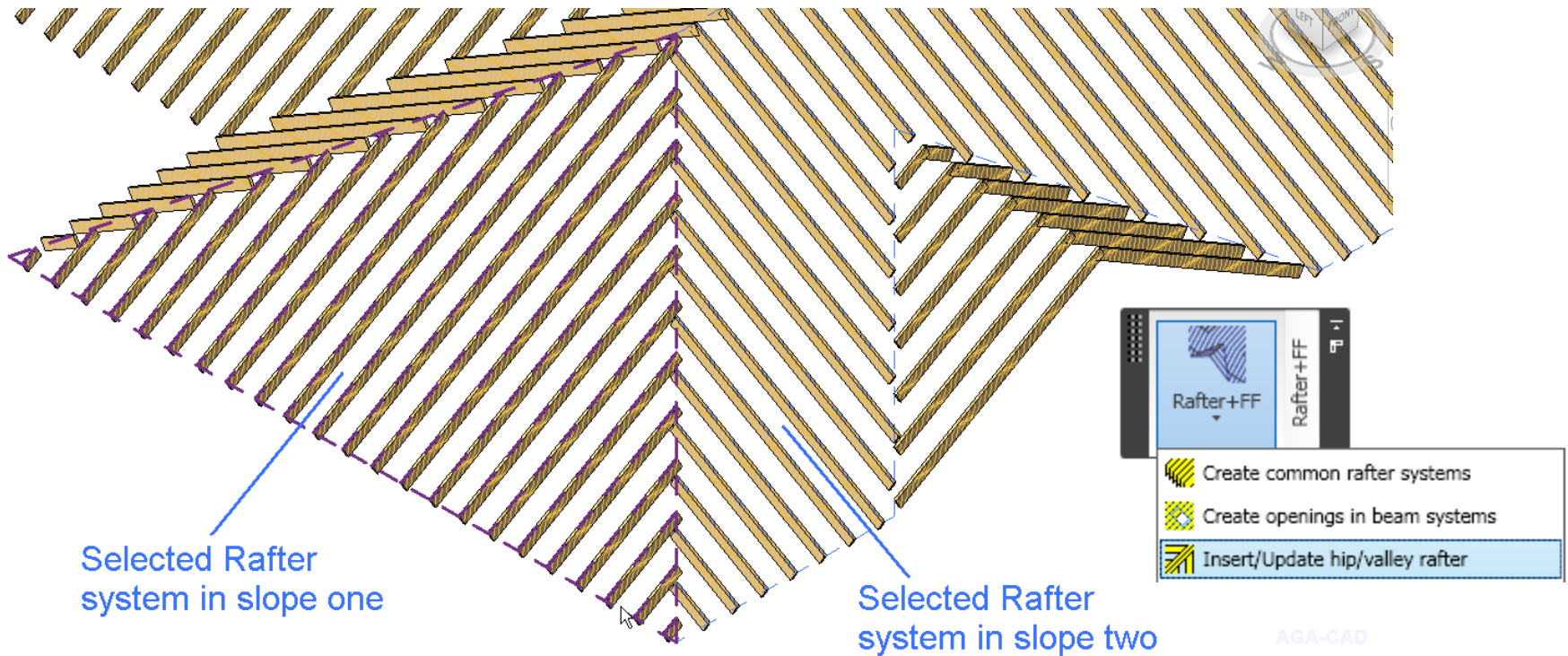

# Configure Hip/Valley Rafter

- Now you can choose *End cut type* of a rafter.
- Provide dimensions of the rafter cross section: *width - b* and *height (depth) – h (d)*.
- Enter the *End cut height* dimension **h1** if required.
- Click *OK* to create Hip Rafter.

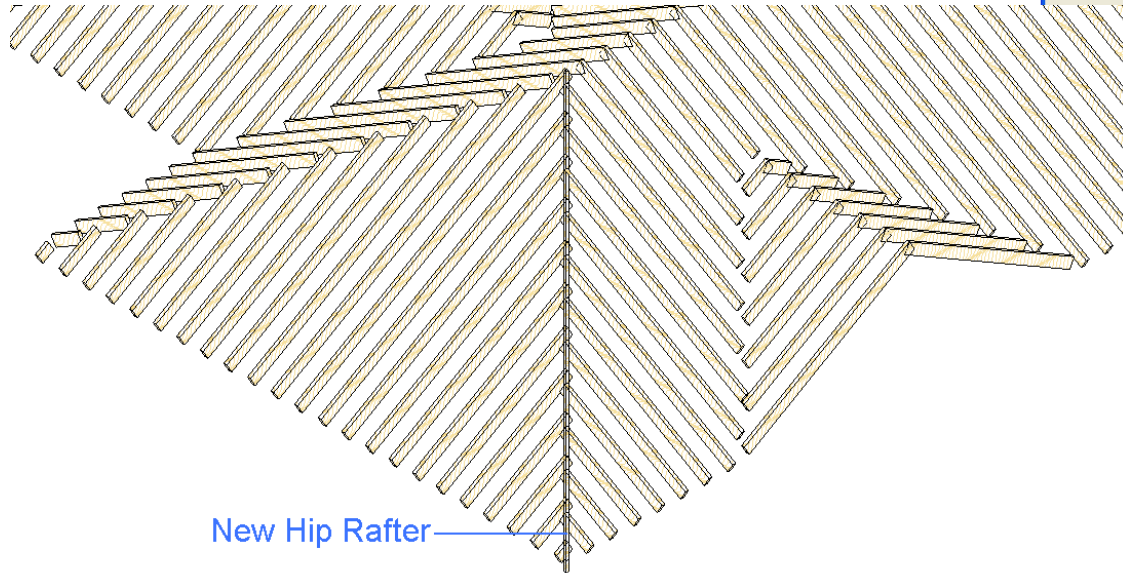
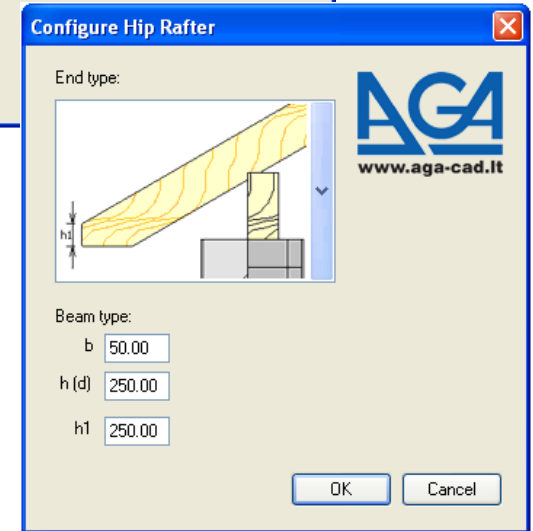

New Hip Rafter

# Update Existing Hip/Valley Rafter

- Select the hip/valley rafter or multiple hip/valley rafters you want to update.
- Select the function *Insert/Update hip/valley rafter* from the menu.
- Make your changes for *End cut type* of the rafter or *Cross section dimensions* and click *OK*.

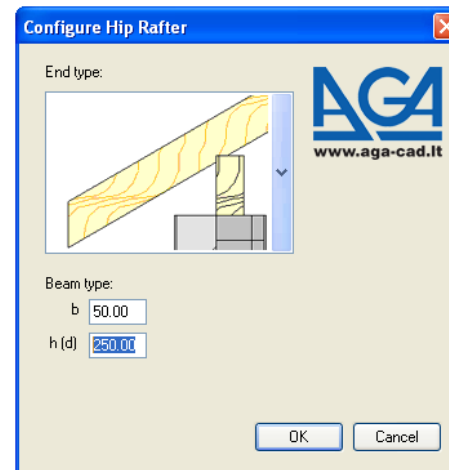
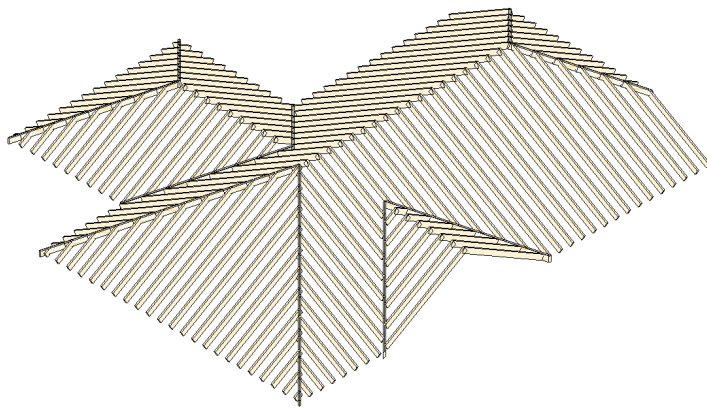
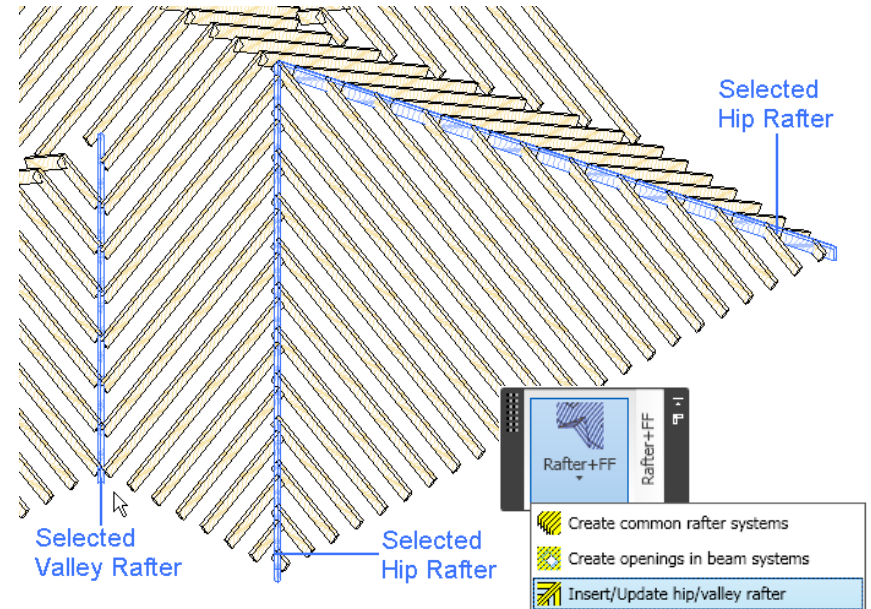

# Increase your productivity !



AGA CAD Ltd.  
Zalgirio 112A, LT-09300 Vilnius,  
Lithuania  
Tel. +370 5 2398111  
Fax +370 5 2398113  
Email [info@aga-cad.lt](mailto:info@aga-cad.lt)  
[info@tools4revit.com](mailto:info@tools4revit.com)  
[www.tools4revit.com](http://www.tools4revit.com)